

## Instruction Manual Compressor Nebulizer NE-C106

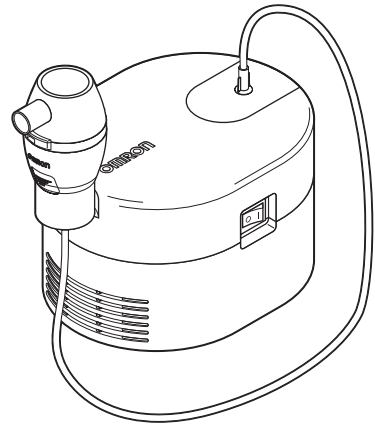

Thank you for purchasing the NE-C106. This product was developed in conjunction with respiratory therapists for the successful treatment of asthma, chronic bronchitis, allergies and other respiratory disorders. This is a medical device. Operate the device only as instructed by your doctor and/or respiratory therapist.

All for Healthcare

2875793-4B  
Issue date: 2021-03-03

### Precautions for Use

- Read all the information in the instruction manual and any other literature included in the box before using the device.
- Warnings and cautions described in the instruction manual should be observed.

**Warning**  
Indicates a potentially hazardous situation which, if not avoided, could result in serious injury.

**Caution**  
Indicates a potentially hazardous situation which if not avoided, may result in minor or moderate injury, or physical damage.

- Keep these instructions for future reference.

### Intended Use

#### Medical Purpose

This product is intended to be used for inhaling medication for respiratory disorders.

#### Intended User

- Legally certified medical experts, such as doctor, nurse and therapist.
- Caregiver or patient under the guidance of qualified medical experts for home treatment.
- The user should also be capable of understanding general operation of NE-C106 and the content of instruction manual.

#### Intended Patients

This product should not be used on patients, who are unconscious or are not breathing spontaneously.

#### Environment

This product is intended for use in a medical facility, such as hospital, clinic and doctor's office, and in a room of general household.

#### Durable Period

Durable periods are indicated in the table on the right, provided the product is used to nebulize saline 3 times a day for 10 minutes each time at the specific environment indicated below. Durable period may vary depending on usage environment.

Frequent use of the product may shorten the durable period.  
Operating environment: 23±5 °C, 30 to 70 %RH, standard atmosphere (1013.25 hPa), rated power

Compressor (Main unit)	5 years
Nebulizer kit	1 year
Mouthpiece	1 year
Air tube (PVC)	1 year
Air filter	60 days
Mask	1 year

### How the Nebulizer Kit Works

The medication that is pumped up through the medication channel is mixed with compressed air which is generated by a compressor pump. The compressed air mixed with medication is turned into fine particles and sprayed when in contact with the baffle.

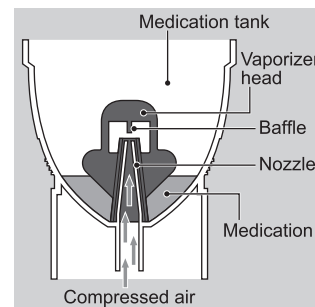

### Know Your Unit

#### Compressor (Main Unit)

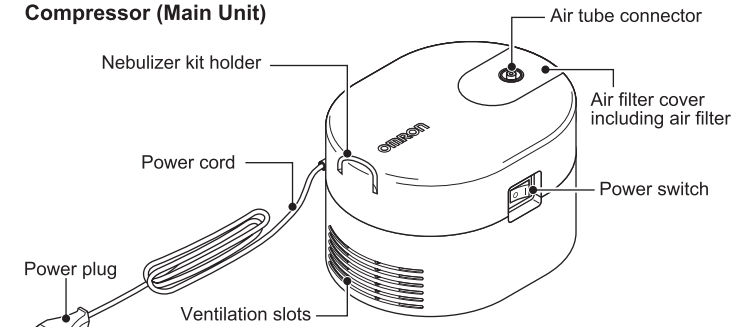

#### Nebulizer Kit

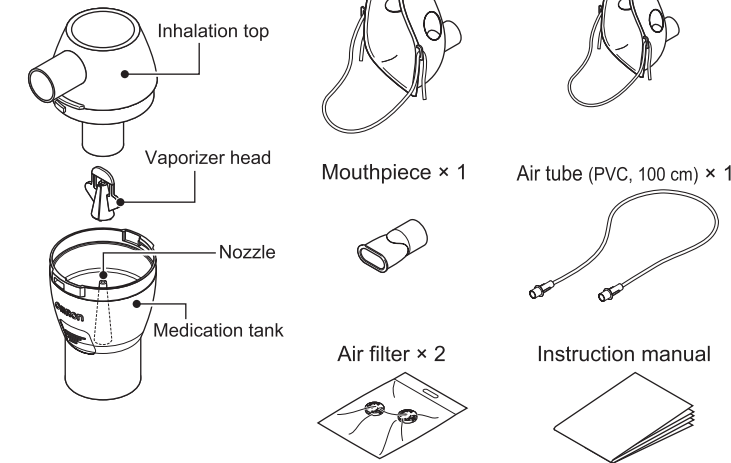

### Cleaning and Disinfecting

#### Warning

Clean and disinfect the nebulizer kit, mask, mouthpiece before using them when as follows:

- the first time after purchase
- if the device has not been used for a long period of time
- if more than one person uses the same device

#### Cleaning

Clean the parts after each use to remove residual medication. This will avoid inefficient nebulization or infection.

Washable Parts			Non-Washable Parts		
Nebulizer kit	Mask	Mouthpiece	Compressor	Air tube(PVC)	Air filter

#### Washable Parts

Remove the inhalation top from the medication tank.

[1] Rotate the inhalation top anti-clockwise.

[2] Lift the inhalation top out of the medication tank.

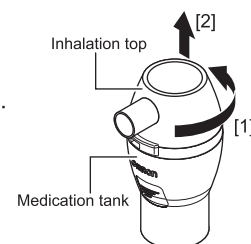

#### Inhalation top, medication tank, mask, mouthpiece

Wash them in warm water and neutral (mild) detergent. Rinse them thoroughly with clean hot tap water and allow to air dry in a clean place.

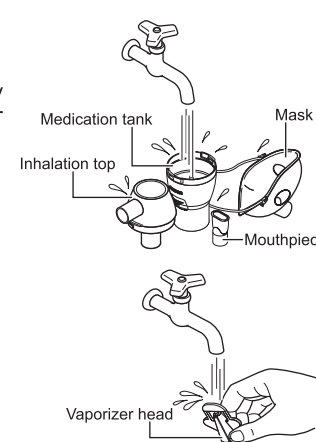

#### Vaporizer head

Wash it with running water.

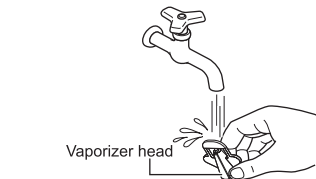

#### Caution

#### Handling the Vaporizer Head

- Always wash the vaporizer head after each use.
- Do not use a brush or pin to clean the vaporizer head.
- When disinfecting the parts by boiling, be sure to boil them in plenty of water.
- Do not boil vaporizer head together with objects other than applicable nebulizer accessories.

#### Non-washable Parts

##### Compressor, air tube (PVC)

Firstly, make sure that the power plug is unplugged from the power outlet. Moisten a soft cloth with water or neutral (mild) detergent and wring it out. Wipe clean with the cloth.

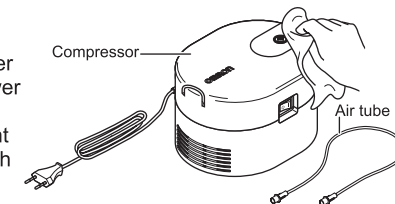

##### Air filter

Do not wash or clean the air filter. If the air filter becomes wet, replace it. Damp air filters can cause blockages.



### Disinfecting

Disinfect the parts once a week. If the parts are heavily stained, replace them with new ones.

There are 2 disinfecting methods.

[A] Use a commercially available disinfectant. Follow the instructions provided by the disinfectant manufacturer.

#### Note

Never clean with benzene, thinner or a flammable chemical.

[B] Parts may be boiled between 15 to 20 minutes. After boiling, carefully remove the parts, shake off excess water and allow to air dry in a clean environment.

To select a method for disinfection, refer to the table below.

○: applicable -: not applicable

Disinfecting method	Parts	Mouthpiece	Nebulizer kit	Adult mask Child mask	Air tube	Air filter
		Materials	PP	PP	Mask: PE+POE Band: Rubber***	PVC
[A] Alcohol Disinfecting ethanol		○	○	○**	-	-
[A] Sodium hypochlorite Milton* (0.1%, 15 min.)		○	○	○**	-	-
[B] Boiling		○	○	-	-	-

\* An example of commercially available disinfectant. (The concentration and residence time specified in the table are under the conditions where the service life of the parts is tested with each disinfectant used as described in its instruction manual. Please note that the testing was not performed for the purpose of ensuring the effectiveness of the disinfectants. There is no intention of suggesting that such disinfectants be used. Conditions of use and ingredients of disinfectant vary for manufacturers. Please read the instruction manuals carefully before use and apply disinfectant to each part in an appropriate way. Please notice that service life of the parts may be shorter depending on conditions, environments and frequency of use.)

\*\* Remove the rubber band from mask before disinfecting.

\*\*\* The band not made with natural rubber-latex.

### How to Use

**1 Make sure that the power switch is in the OFF ( O ) position.**

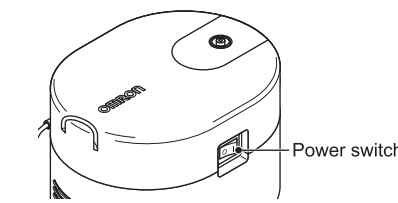

**2 Plug the power plug into a power outlet.**

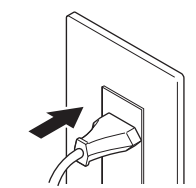

#### Note

Do not place the device in a location where it is difficult to disconnect the power cord.

**3 Remove the inhalation top from the medication tank.**

[1] Rotate the inhalation top anti-clockwise.

[2] Lift the inhalation top out of the medication tank.

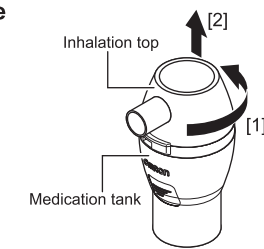

**4 Make sure that the vaporizer head is placed in the medication tank.**

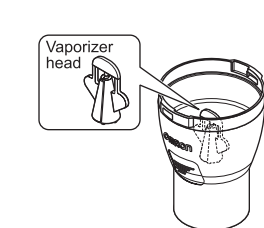

**5 Add the correct amount of prescribed medication to the medication tank.**



**6 Put the inhalation top back onto the medication tank.**

[1] Lower the inhalation top on the medication tank.

[2] Rotate the inhalation top clockwise.

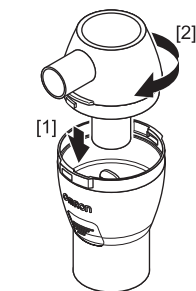

**7 Attach the mouthpiece or mask to the nebulizer kit tightly.**

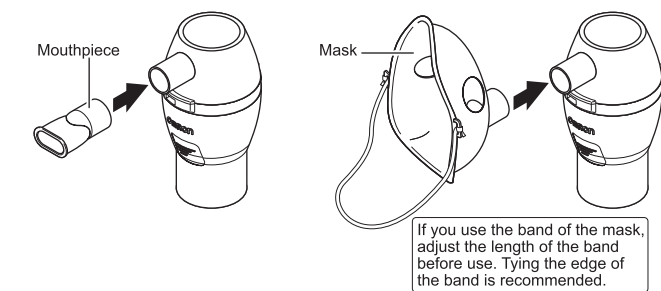

If you use the band of the mask, adjust the length of the band before use. Tying the edge of the band is recommended.

**8 Attach the air tube to the compressor and nebulizer kit.**

Twist the air tube plug slightly and push it firmly into the air tube connector.

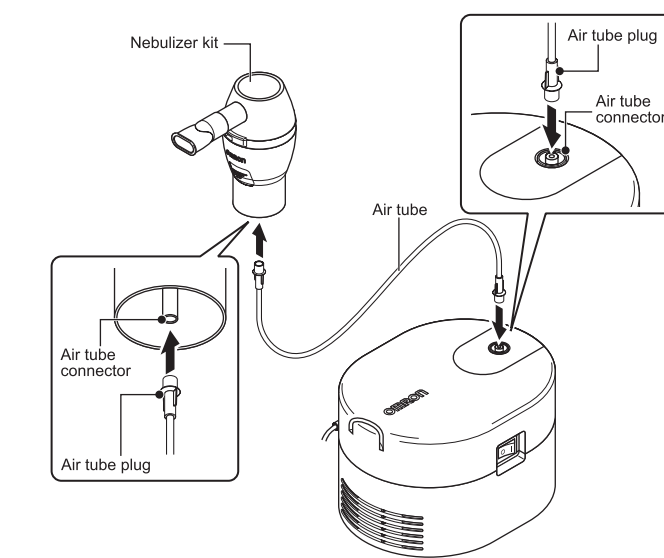

**9 Hold the nebulizer kit.**

#### Caution

Do not tilt the nebulizer kit at an angle of greater than 30 degrees in all directions. Medication may flow into the mouth or it may result in not nebulizing effectively.

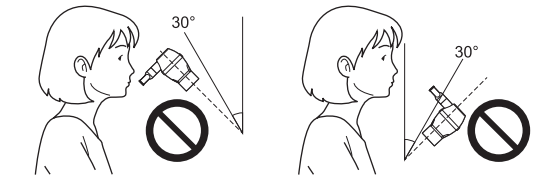
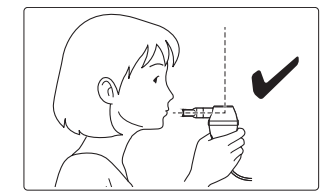

**10 Turn the power switch to the ON ( | ) position.**

As the compressor starts, nebulization begins and aerosol is generated.

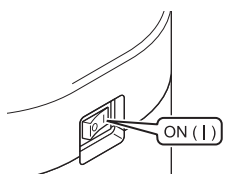

**11 Inhale the medication.**



**12 When treatment is complete, turn the power off and unplug the power plug from the power outlet.**

